

- 1 Power supply input 230 V AC
- 2 Output relay contact „Emergency“ A + B
- 3 Output relay contact „Error“ and „Power failure“
- 4 Input 24V-DC emergency power supply
- 5 Input backup amplifier
- 6 Speaker line 1-12
- 7 Fire brigade call station 1 (FWS1 with priority of FWS2)
- 8 Fire brigade call station 2 (FWS2)
- 9 Input for annunciator 1-3
- 10 Input for annunciator 4-6
- 11 Line-level input program 1
- 12 Line-level input program 2
- 13 Line-level output for Equalizer
- 14 Line-level input for Equalizer
- 15 Line-level output for 100V amplifier 1-6
- 16 Line-level output for 100V backup amplifier
- 17 Contact input to activate program 2
- 18 Memory card for Textmessages
- 19 Serial Interface RS232 for Printer
- 20 Digital Interface RR-120 (optional)

Technical data	VARES ESC-012A
Speaker lines	12 lines, max. 480 W each (6 lines with ELM-106)
Fire Brigade call stations	2x ESM-100D suitable for connection
Digital microphone stations	up to 10 devices ELM-106 (not monitored)
Signal outputs	13x NF 0dB; transformer balanced; 12 x 100V
Signal inputs	2x NF 0dB; unbalanced (Prg 1 + Prg 2); 13x 100V; 6x supervised switching inputs for text or alarm activation (input 6 has a special function to analyse external errors r)
Switching outputs (max. 120V AC; max. 2A AC)	2x „Emergency“ (break or open contact) 1x „Error“ (break or open contact) 1x „Power failure“ (break or open contact)
PC-interface	RS-232
Voice memory	SD-card
Display	LCD 64 x 128 px, LEDs
Control panel	2 buttons, 6 programming buttons, selection wheel
Power supply	230V AC, 24V DC
Power consumption	< 40 W
Dimensions (WxHxD)	483 x 89 x 340 mm, 2 RU
Weight	6,7 kg

Digital Microphone Station



Description

ELM-106 manages announcements into one or more selected zones and all-calls. An expansion to handle 12 call zones is possible by the use of an optional six-button module ELE-006.

- On an overall bus length of 100 m on CAT7 cable up to ten pcs. ELM-106 can be connected to a single ESC-012A. For larger distances please use lower resistance cables.
- With the extension module ELE-004 can be extended to a covered alarm button, three buttons for special functions and 2 fault LED's .

Digital Microphone Station, Electret microphone with cardioid characteristic	ELM-106
Digital Microphone Station, as ELM-106, but without interface RR-120	ELM-106 WO
Button Extension Module, for ELM-106 to handle 12 call zones.	ELE-006
Function Extension Module, for ELM-106 to expand with further functions	ELE-004



Lifesaving in the case of an emergency!

In the case of an alarm, an electroacoustic emergency warning system may avoid panic by understandable speaker announcements, which are, contrary to the howling of a siren, a much more efficient way of initiating the evacuation of a building.

Certainly, the availability and safe working of such systems has to be guaranteed at any time by monitoring the complete signal path. The standard **IEC 50849/VDE 0828 and VDE 0833-4** defines the requirements for such systems.

Description Control-Center ESC-012A

VARES ESC-012A has been developed in full accordance to the latest rules and regulations for security. Targeted towards small and medium-scaled usage scenarios, it handles all the tasks and challenges a voice alarm systems faces in everyday life.

Installation is handled in an easy and straightforward way by using the LCD based user interface. All connected auxiliary components are scanned and registered automatically.

Speaker lines can be configured in 12 single or 6 A/B lines for an increased security. Even a mix of single and redundant line setups for custom scenarios is possible.

A logging function stores all system conditions on non-volatile memory in any case of a technical failure. The generated protocol can be viewed immediately or sent to a printer.

Specifications:

- Graphical user interface with adjustable colour scheme, in any case of an alarm the display flashes in red colour.

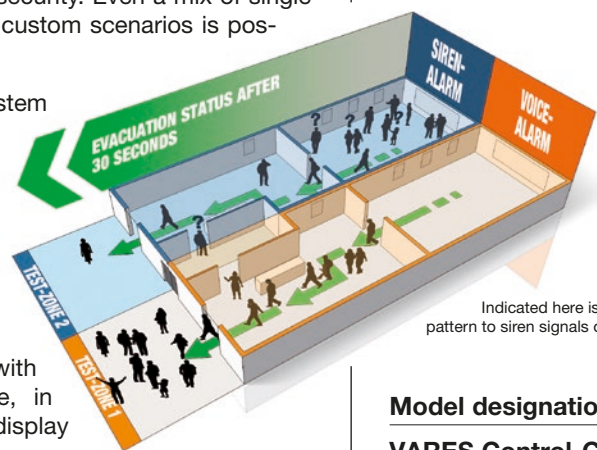

Indicated here is the different reaction pattern to siren signals or a spoken message.

- Menu interface with digital rotary encoder.
- Password protected menu interface.
- Fully variable assignment of up to 12 speaker lines to a maximum of 6 power amplifiers, maximum amplifier power is 480 W each.
- A faulty power amplifier is detected and replaced by the backup amplifier automatically.
- Two line level inputs of different priority levels can be used for various tasks, like background music distribution or paging via a telephone system.
- Free assignment of the program to any of the 12 speaker lines.
- The internal digital message memory (based on an SD card) is equipped with an evacuation announcement, a siren according to DIN 33404 and various different chimes (one tone and four tones).
- All 12 speaker lines are monitored for short circuits, line breaks and impedance variation.
- Error messages are provided by clear text display, signalling LED, sounder and dry contact.
- Up to 10 digital call stations ELM-106 can be connected.
- ELM-106 call stations can be expanded to address 12 zones by ELE-006 expansion units.
- Emergency microphones ESM-100D and ESM-020H enjoy individual 3-band equalisation for best intelligibility of any announcement (up to two emergency microphones can be connected).

Model designation

VARES Control-Center, 2 RU **ESC-012A**