



Description

The DVM-210A is a Class-D technology digital stereo amplifier module with an output power of 20W per channel.

The four-stage rotary switch behind the transparent front flap allows the setting of four different gains to adapt to existing audio input level.

The multi-color LED shows the operational readiness and stays green. In case of overload, the LED lights up red in the signal beat.

Please consider the following features:

- Easy installation and installation costs.
- Placement in subdivisions possible, the module width is only 1 HP (horizontal pitch).

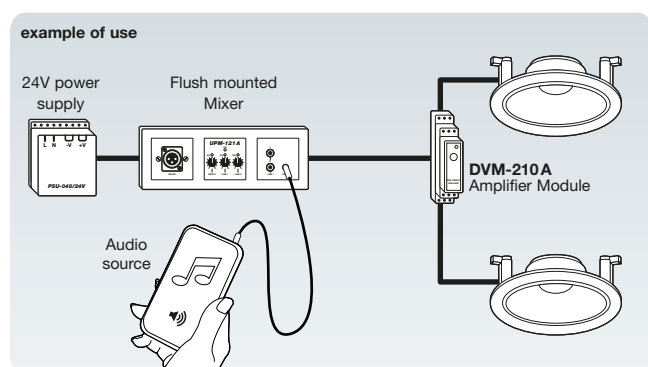

- Low heat generation by digital circuitry.
- Protective circuit against short circuit, reverse polarity and overheating.

★

Technical data	DVM-210 A
Output power at 24V	2x 20 W on 4 ohms / 2x 10 W on 8 ohms
Frequency range -3dB	40 – 30.000 Hz
Audio inputs	unbalanced
Protection circuits	thermal, short circuit, reverse polarity
Rotary switch (4 gain stages)	20dB, 26dB, 32dB, 36dB
Input level	0dB, -6dB, -12dB, -16dB
input resistance	60kohms, 30kohms, 15kohms, 10kohms
Output impedance	4 ohms
Operating voltage	24 V DC
Current consumption at 24V/max.	45mA/2A
Connections	screw terminals up to 2,5 mm ²
Weight	65 g
Dimensions (WxHxD)/horiz. pitch	89,7 x 62,2 x 17,8 mm; 1 HP

Model designation

Digital Audio Amplifier Module **DVM-210 A**
2x20W, suitable for DIN rail mounting, 1 HP