

VOICE EVACUATION CEILING SPEAKER

EN 54-24 CERTIFIED

RCS

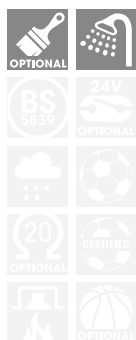

2x **6W** Adaptions
1,5/3/6 W

100 V

PASSI

ACTIVE



Certificat No.
1438-CPR-0475



Description

This loudspeaker is tested by a notified product certification authority and certified to EN 54-24:2008.

This built-in loudspeaker made of plastic-coated metal is equipped with 2 loudspeakers as well as with 2 transformers and thus allows in a space-saving and elegant way an A / B distribution and cabling of the required alarm loudspeaker according to **DIN EN 50849 / VDE 0828 and VDE 0833-4.**

Regarding the rear plastic cover and the flat design, this speaker is suitable for installations with low installation depth.

Please consider the following features:

- 2 strong broadband speakers for best voice and music reproduction.
- Fast and uncomplicated assembly with spring clamps and short tension distance
- The simple, modern mounting method adapts to all standard ceiling thicknesses of 3 - 45 mm.

- 2 pieces 2-pin ceramic terminal with thermal fuse.
- Temperature resistance of -20/+55° C
- Protection class IP21C
- Speaker with moisture impregnation
- The speaker comes with an innovative anti-static PET plastic contact protection (plastic cover).



Technical data	SRC-612 EN
Nominal load capacity (music load cap.)	2 x 6 (15) W
Adjustments at 100 V	2 x 6-3-1,5 W
Frequency range	101 – 22.900 Hz
Sound pressure 1 W/1 m	89,0 dB
Sound pressure Pmax/4 m	89,7 dB
Sensitivity 1 W/4 m, EN54-24	79,0 dB
Beam angle -6dB 1/2/4 kHz	180°/137°(v)/77°(h)/49°(v)22°(h)
Hole cut-out Ø	218 mm
Outside dimensions x installation depth	246 mm x 68 mm
Weight, colour	1,1 kg; white (similar to RAL 9010)

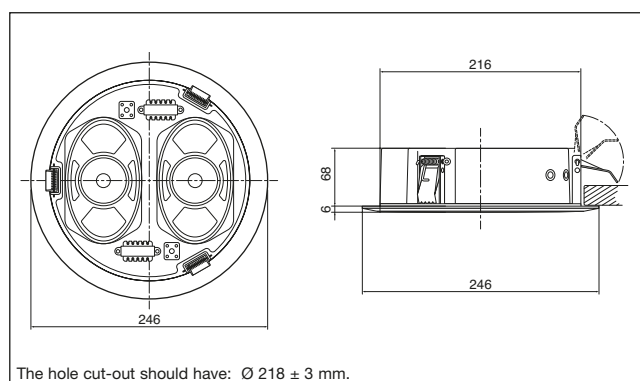

Model designation

Alarming Ceiling-Speaker **SRC-612 EN**
2x 6 W, with 2x 100V-transformer and dust cover